

EXITE PRO HIGH BAY

Warning:

1. Please read the manual carefully before installation.
2. The luminaire must be installed by qualified electrician in accordance with local rules and codes.
3. Switch off main power supply before installation, maintenance and any operation.
4. The light source contained in this luminaire shall only be replaced by the manufacturer or his service agent or a similar qualified person.
5. The external flexible cable or cord of this luminaire cannot be replaced; if the cord is damaged, the luminaire shall be destroyed.
6. Ensure power supply cables (L-N/L-N-E) are connected correctly before switching on, including whole use process that the earthing contact is always reliably linked to earth ground.
7. The luminaire should avoid storage and usage in such a surroundings or an occasion that is with corrosion or hazardous gases like sulfide, halide, phthalate, ethylamine, tetra-dichloroethylene and so on.
8. The Luminaire and wiring connection should never be used in submerged wet conditions e.g. under water, soil, snow etc.
9. To adjust the output power and color temperature, you need to operate after AC OFF.
10. The regular sensor could not be used with Emergency Driver at the same time. If the sensor should be worked with Emergency Driver at the same time, please ask for a special type.
11. Use IP65 grade connection devices with cable clamp to ensure a complete IP65 system.
12. The warranty is void, in case any of the instructions/guidelines are not followed as per given mounting instruction.
13. This product is not supplied with any junction box/connector

Installation instruction:

Wiring Diagram

AC cord



label

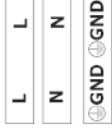

0-10V dimmable



label

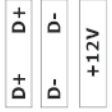

Fasten safety cable

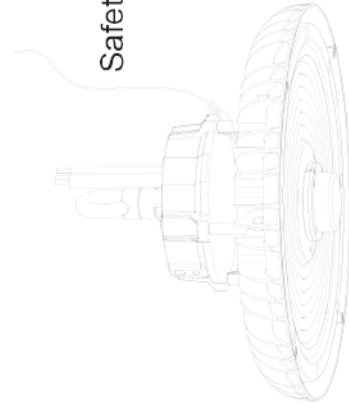

Safety rope position

1

Twist in sensor installation manual

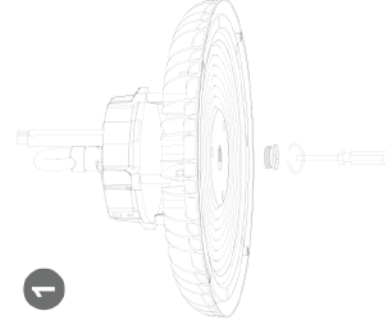

Take out cover cap

2



Twist in sensor

3

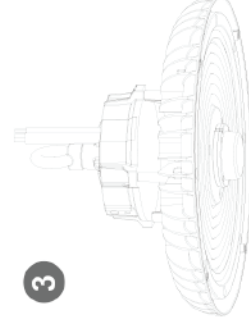

Finished installation

Lamp must fasten individual safety cable

The safety rope is not included, if necessary please purchase from the seller and clarify the length.



Attention: Sensor should be properly tightened to make it waterproof

Hole dimension for mounting (inch)

100W/150W/200W/240W/300W

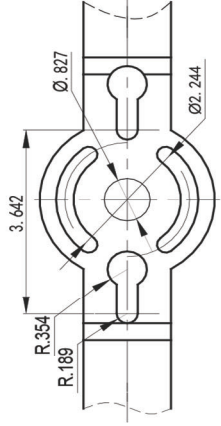
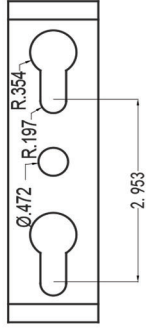

LED light dimension

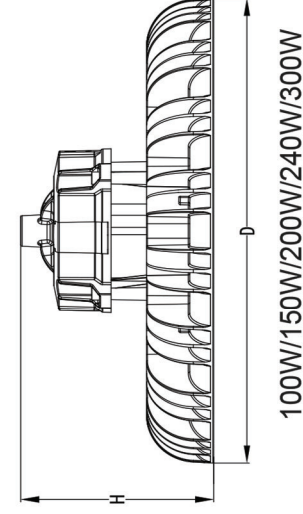

| Power | Diameter D(inch) | Height H(inch) |
|-------|------------------|----------------|
| 100W | 11.024 | 4.921 |
| 150W | | |
| 200W | | |
| 240W | 12.598 | 4.921 |
| 300W | | |

CCT and Watt selected Operation Manual

1. Open the knock-out, which is on the driver.

2. Slide the switch to select according wattage and CCT.

3. Close the knock-out on the driver, make sure its well-sealed.

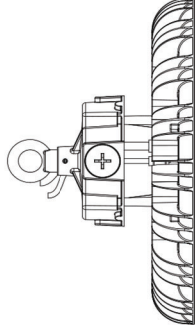
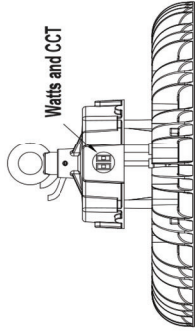
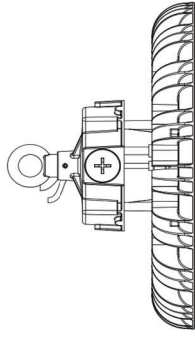

| CCT | A(CW) | A+B(NW) | B(WW) |
|------------|-------|---------|-------|
| 3000~5000K | 5000K | 4000K | 3000K |
| 4000~5700K | 5700K | 5000K | 4000K |

| Power | HIGH(A) | MID(B) | LOW(C) |
|-------|---------|--------|--------|
| 100W | 100W | 80W | 60W |
| 150W | 150W | 120W | 80W |
| 200W | 200W | 150W | 120W |
| 240W | 240W | 200W | 150W |
| 300W | 300W | 240W | 200W |

Installation

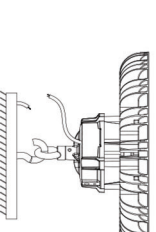
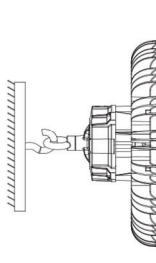
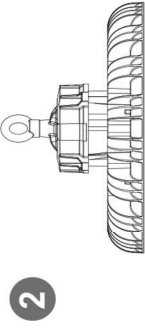
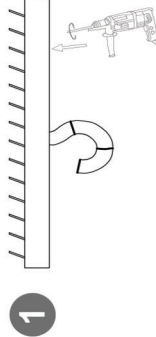

Drilling holes in the ceiling, and install the expansion hook.

Ring mounted lamp.

Install the lamp on the hook

Connect the cables, Take care of the waterproof processing.

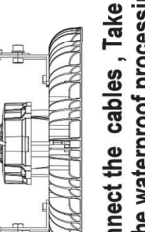
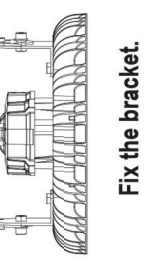
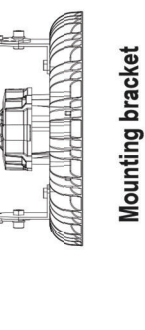
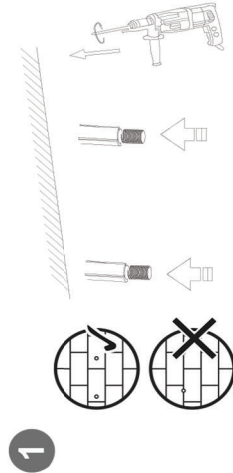

Drilling holes in the ceiling, and install the expansion screws.

Mounting bracket

Fix the bracket.

Connect the cables, Take care of the waterproof processing.

Fasten safety cable

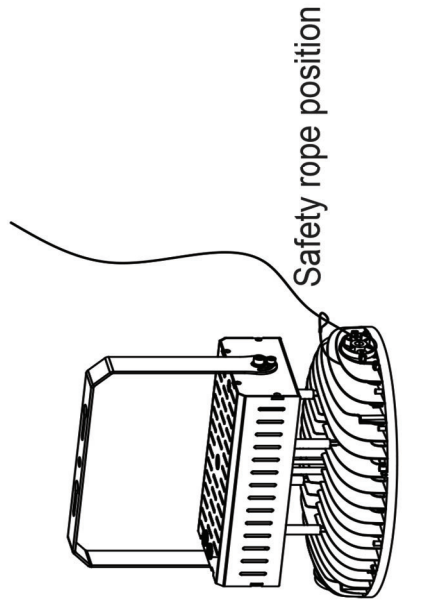

Safety rope position

1

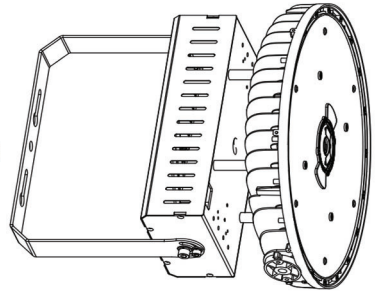

2

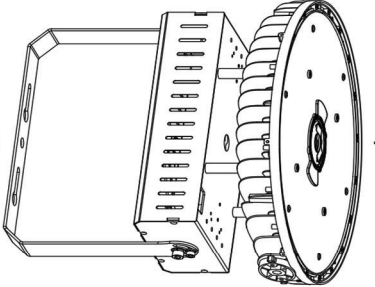

Twist in sensor

3

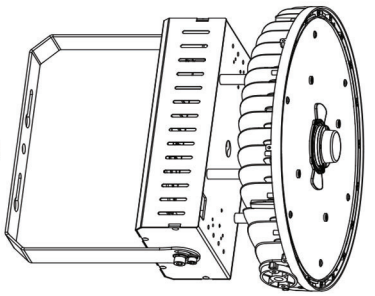

Finished installation



Lamp must fasten individual safety cable

The safety rope is not included, if necessary please purchase from the seller and clarify the length.

Attention: Sensor should be properly tightened to make it waterproof

Twist in sensor installation manual

Hole dimension for mounting (inch)

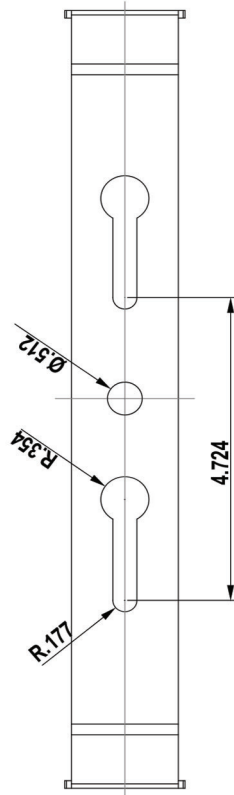

LED light dimension

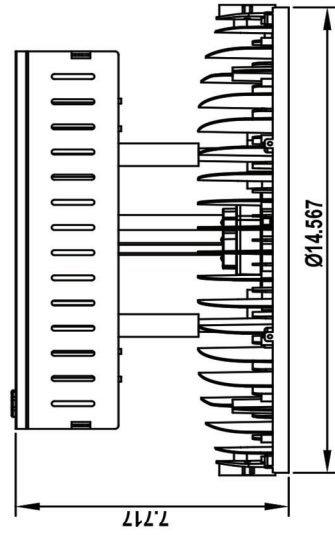

CCT and Watt selected Operation Manual

1. Open the knock-out, which is on the driver.

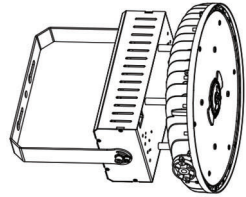

2. Slide the switch to select according wattage and CCT.

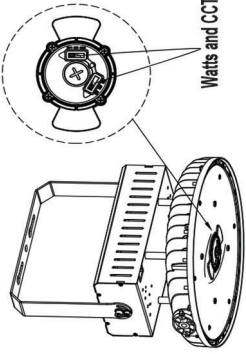

3. Close the knock-out on the driver, make sure its well-sealed.

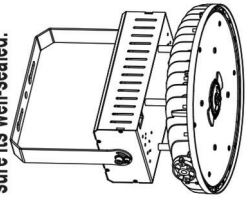

| CCT | A(CW) | A+B(NW) | B(WW) |
|------------|-------|---------|-------|
| 3000~5000K | 5000K | 4000K | 3000K |
| 4000~5700K | 5700K | 5000K | 4000K |

| Power | HIGH(A) | MID(B) | LOW(C) |
|-------|---------|--------|--------|
| 500W | 500W | 400W | 300W |

Installation

1

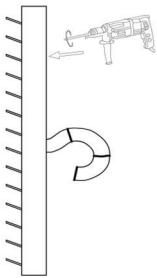

Drilling holes in the ceiling, and install the expansion hook.

1

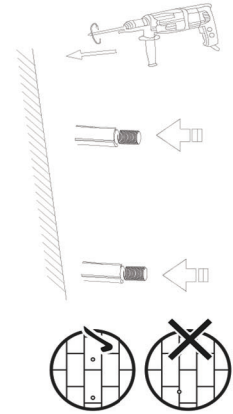

Drilling holes in the ceiling, and install the expansion screws.

2

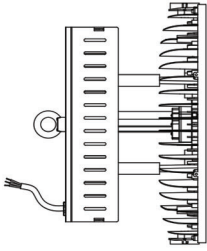

Ring mounted lamp.

2

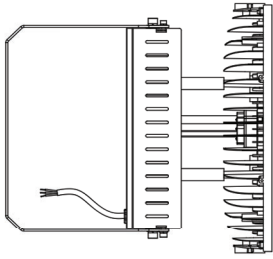

Mounting bracket

3

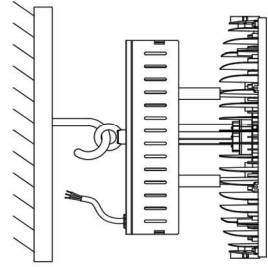

Install the lamp on the hook

3

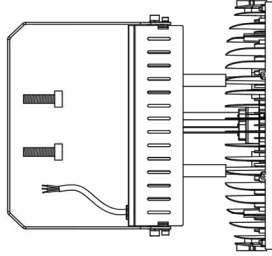

Fix the bracket.

4

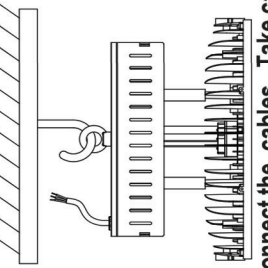

Connect the cables , Take care of the waterproof processing.

4

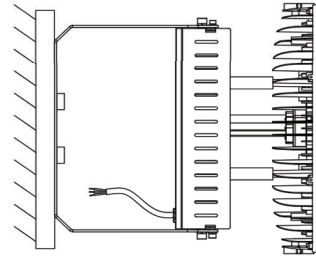

Connect the cables , Take care of the waterproof processing.