

## Product Description

The Axis series is available with a swivel pendant and is designed with three optical outputs to replace HID lighting systems up to 100w. Typical lighting applications include retail centers, industrial parks, schools and universities, public transit and airports, office buildings and medical facilities. Mounting can be accomplished up to heights of 12 feet.

> Quick Ship - In Stock, Ready to Ship

Project:		Type:
Location:		
Prepared By:		Date:
Comments:		

## Performance Summary

- Samsung COB LEDs with high efficacy >115 Lm/W
- Buy American Act and ARRA compliant
- Quick Ship - In stock and ships from six locations for quick delivery
- USA assembled product with quick warranty support
- Modern, architectural design with a streamlined appearance
- Patented heat dissipation design for optimum efficiency
- National listing lab tested to IES standards with NEMA optics
- High lumen maintenance exceeds DOE requirements
- White reflector built around the LED for enhanced light distribution
- Aluminum LED boards with copper tracings for best thermal management
- LED array manufactured using a state-of-the-art SMT machine
- Tempered clear borosilicate flat glass lens
- A360 extruded ingot die-cast housing, front frame and ballast box
- DuPont textured architectural bronze powdercoat finish
- Chromate conversion coating for long lasting appearance
- Mounts with Pendant Mount with 1/2" conduit (not included) and 3/4" accessories
- Rust resistant stainless steel hardware with durable nickel-plating
- Fin heatsinks for best heat dissipation and long life
- High CRI - RA>80 enhances original colors
- 0-10V dimmable driver with surge protection option
- Fast turn on with no warm up or cold start issues
- Contains no mercury, lead, infrared or UV radiation and cool to the touch
- Operating temperature: -40 to 50 degrees celsius
- Samsung chip platform with completed 6,000 hour LM-80 test
- 89,000 hour LED life @ L70 tested at 25 degrees celsius
- Certifications: CE, RoHS, CSA - IP66 outdoor rated
- 10 year limited warranty

## AXIS BULLET PENDANT

LED Dimmable Luminaire

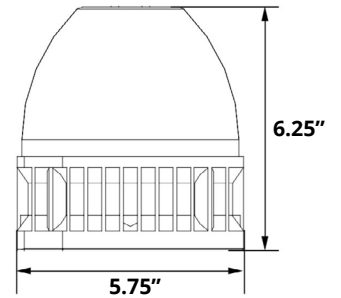

## Models:

- WDFB1C3P: 20W - 2372 Lm - 525 mA

Ordering Information:				Part Number:		
*Adder Applies		**Adder Applies. Extended Lead Time.		Ordering Example: WDFB1C3P-41-S5C-V27-BZ-ND		
Family	CCT	Optic	Voltage	Finish	Dimming	Accessories*
WDFB1C3P	41 - 4100K	S5C - NEMA 6Hx6V with 70 Degree Reflector  S5P - NEMA 6Hx6V with 100 Degree Reflector*  S4P - NEMA 4Hx4V with 30 Degree Reflector*	V27 - 120-277V	BZ - Bronze CS - Custom**	ND - Non Dim DM - 0-10V Dim	SP - 20kA Surge Protection 120-277VAC C1 - Backplate with 1/2" Coin Plugs PR - Round Swivel Pendant Mount for 3/4" Conduit PS - Square Swivel Pendant Mount for 3/4" Conduit



Vivid Leds, Inc.  
PO BOX 9  
Sellersburg, IN 47172  
800-974-3570  
www.vividleds.us

Dimensions, specifications, and product pictures are subject to change without notice.

B10