

## Product Description

The Industry series is a semi cutoff wall pack luminaire providing lower direct glare while increasing efficiency over full cutoff optics, and is designed to replace HID lighting systems from 250w to 400w. Typical wall mounted lighting applications include retail centers, industrial parks, schools and universities, public transit and airports, office buildings and medical facilities. Mounting heights of 18 to 30 feet can be achieved.

> Quick Ship - In Stock, Ready to Ship

Project:		Type:
Location:		
Prepared By:		Date:
Comments:		

## Performance Summary

- Samsung LEDs with high efficacy >135 Lm/W
- USA assembled product with quick warranty support
- Standard design with modern components, excellent choice for retrofitting
- Patented heat dissipation design for optimum efficiency
- National listing lab tested to IES standards with Type IV optic
- High lumen maintenance exceeds DOE requirements
- Solid State with high-shock and vibration resistance
- Aluminum LED boards with copper tracings for best thermal management
- LED array manufactured using a state-of-the-art SMT machine
- Molded prismatic borosilicate glass lens with high quality gasket
- A360 extruded ingot die-cast housing with hinged semi cutoff front frame
- Includes safety cable to prevent front frame impact when installing
- DuPont textured architectural bronze powdercoat finish
- Chromate conversion coating for long lasting appearance
- 1/2" coin plugs with o-rings for conduit and photocell
- Cast-in template for mounting directly over a 4" recessed outlet box
- Accessible to mount by 1/2" surface conduit
- Includes easy-hang "two hands free" wall mounting plate with leveling device
- Rust resistant stainless steel hardware with durable nickel-plating
- Fin heatsinks for best heat dissipation and long life
- High CRI - RA>84 enhances original colors
- 1-10V dimmable driver with surge protection and battery backup option
- Fast turn on with no warm up or cold start issues
- Contains no mercury, lead, infrared or UV radiation and cool to the touch
- Operating temperature: -40 to 50 degrees celsius
- Samsung chip platform with completed 6,000 hour LM-80 test
- 144,000 hour LED life @ L70 tested at 25 degrees celsius
- Certifications: CE, RoHS, CSA - IP65 outdoor rated
- 5 year system warranty

## INDUSTRY LC SERIES

Large Semi Cutoff Glass Lens Wall Pack  
LED Dimmable Luminaire

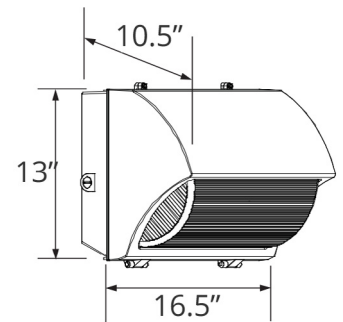

## Models:

- WDWPA25FR: 58W - 7928 Lm

Ordering Information:				Part Number:		Ordering Example: WDWPA25FR-50-S5C-V27-BZ-ND	
*Adder Applies		**Adder Applies. Extended Lead Time May Apply.					
Family	CCT	Optic	Voltage	Finish	Dimming	Accessories*	
VDWPA25FR	30 - 3000K** 40 - 4000K** 50 - 5000K	S4C - Type IV Short	V27 - 120-277V V28 - 347/480V*	BZ - Bronze CS - Custom*	ND - Non Dim DM - 1-10V Dim	SF - Single Fuse DF - Double Fuse SP - 20kA Surge Protection 120-277VAC EM - Emergency Driver Provides 90 Minutes of Backup Power PC1 - Button Photocell 120V PC2 - Button Photocell 250-305V WG - Stainless Steel Wire Guard	



Vivid Leds, Inc.  
PO BOX 9  
Sellersburg, IN 47172  
800-974-3570  
www.vividleds.us

Dimensions, specifications, and product pictures are subject to change without notice.