

A Hanging Mounting

Screw through the hole, rock with screw nut .

1

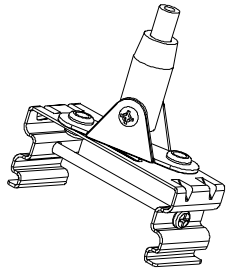
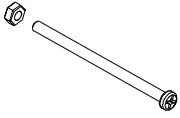

2

Connect the installation fixture and installation shrapnel by steel cable

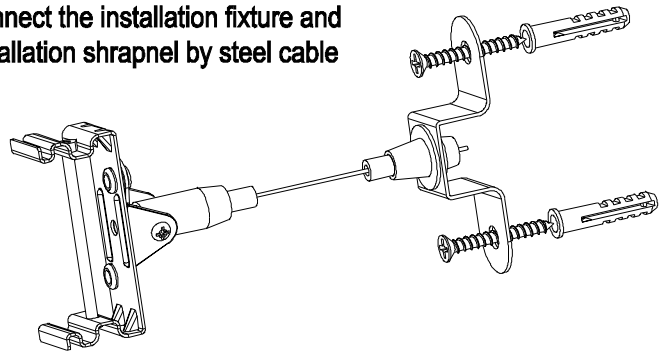

4

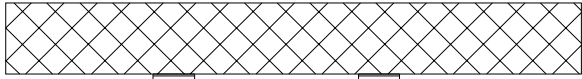

Installation the fixture

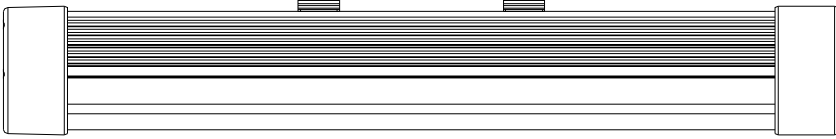

3

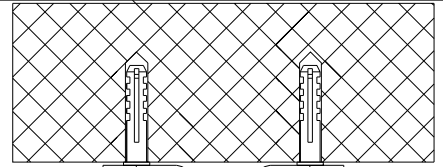

Cutout:6.0mm

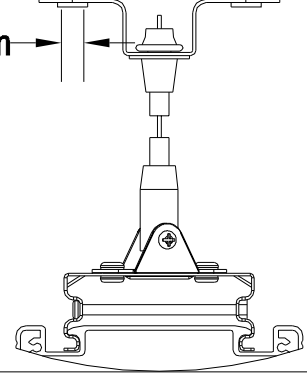

B Ceiling mounting

1

Screw through the hole, rock with screw nut .

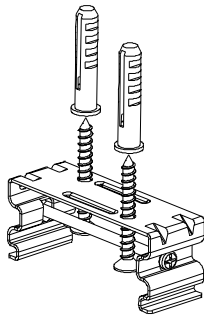
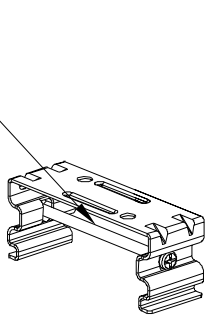
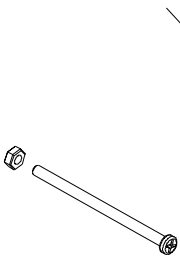

2

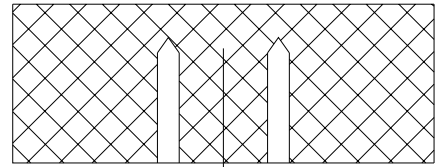

Cutout:6.0mm

Fixed the installation shrapnel at the ceiling

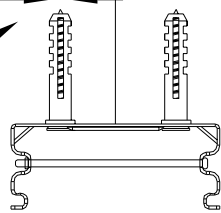

4

Installation the fixture

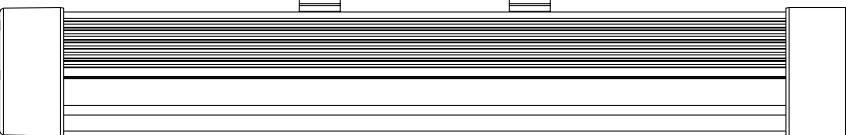

3

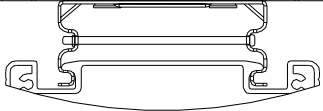
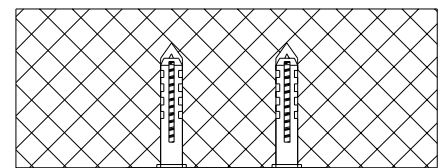

Fixed the installation shrapnel at the ceiling

Noted:Pls make sure that the power off before the installation.