

# LED POOL LIGHT

ITEM NO.: LPL-GM1/2

## INSTRUCTION OF LED POOL LAMP/LPL-GM1/2

This lamps mainly used in swimming pool,or underwater place.Three kinds of functions like Signal color,auto-changing and switch on/off are available for different application.

### A. Specification

#### A-1. Structure

Materials of Shell: 316 stainless steel  
 Input Voltage: 24V DC  
 Protecting Rating: Ip68  
 Operating Temperature: -20°C~40°C



LPL-GM1



LPL-GM2

#### A-2. Model Configuration Table

Model No.	LED Color	LED Quantity	Power Consumption	Input Voltage	Size	Weight	✓
LPL-GM1	R, G, B,WW,W,NW	9P	21 WATTS	24V DC	D140×H60mm	1.6kg±5%	
LPL-GM2	R, G, B,WW,W,NW	12P	29 WATTS	24V DC	D182×H65mm	2.7kg±5%	

### B. Dimension drawing

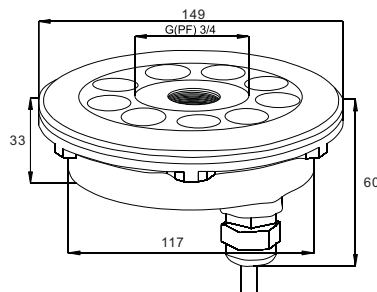

LPL-GM1

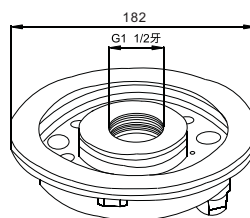

LPL-GM2

Unit: mm

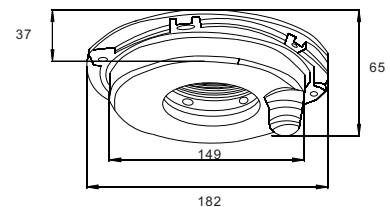

### C. Installation

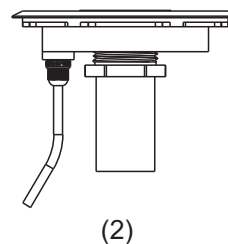
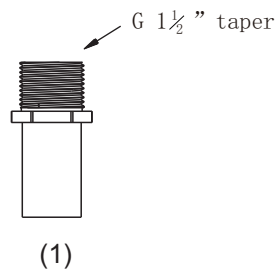

Figure 1: Make the screw tooth size of fountain mouth matched with lights' (size as picture);

Figure 2: Install the lights into fountain mouth clockwise till the bottom of light;

Figure 3: Power the light (normal length of cable is 3M);

# LED POOL LIGHT

ITEM NO.: LPL-GM1/2

## D. Connection

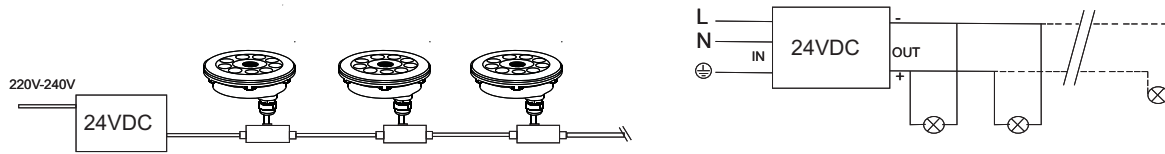

## E. Waterproof treatment (don't put joint part in water)

The wire joint must be sealed with a 20mm thermal shrinking tube, blow and shrink it with a hair driers; thence wrapped with waterproof tape (auto-adhesive, please refer to below instruction for operation) on both side; Blow the second 25mm shrink tube at last so as to protect waterproof tape under sunshine and guarantee the waterproof validity. For detailed instruction pls refer to below picture:

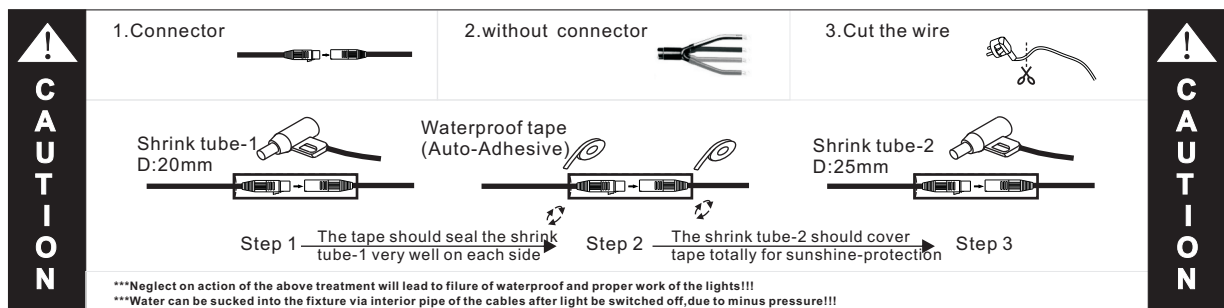

\*\*\* Power connector should be treated in the same way if available!!!

\*\*\* IP68 connector does not require above treatment, but you connect a threaded twist quite well to prevent operational errors lead to joint water

### Caution:

1. Only professional people to make installation, pls check the fixture well before installation;
2. Pls install the lights according to this datasheet carefully, screw the light well and connect the wire correctly.

### Warning:

- \* neglect on action of the above treatment will lead to failure of waterproof and proper working of the lights!!
- \* Make sure the ground connection well avoid electric shock, due to metal housing.

**Note:** The above instruction are subject to update or improved without notice. Pls turn to our staff for further details !  
 Thanks for your long term support !